



LUNIGIANA 2000

real estate

Ref. 012A

Detached house



BESCHREIBUNG

Detached house with **land** of 580 sq m and **outbuilding** requiring renovation set in an hillside position, just 10 minutes far from the beautiful medieval town of Pontremoli.

The property (165 sq m) comprises:

- Entrance hall, bedroom and vaulted cellar on ground floor;
- Landing, kitchen, living room, panoramic **terrace** with amazing views over the valley, hall, double bedroom, bathroom with bath and two vaulted cellars on first floor accessible through an internal staircase.

The outbuilding (55 sq m) to be renovated consists of:

- Veranda entrance hall, kitchen, bedroom and bathroom on second floor.

Central heating (natural gas).

TECHNISCHE DETAILS

Nutzfläche

210 m²

Außenfläche

250 m²

Lärmpegel

0 - zona molto silenziosa

Stockwerke

2

Zimmer

4

Schlafzimmer

3

Badezimmer

2

Garten

580 m²

Grundstück

580 m²

Innenhof

Ja

Keller

Ja

Terrasse

Ja

Höhe ü. d. M.

450

Energieklasse

262.32 Kw/h m²

Status

abitabile

Heizung

Autonomo a gas metano

Panoramablick

Ja

Möbliert

Ja

Kategorie

G

MESSAGES.PROPERTY_IMAGES



































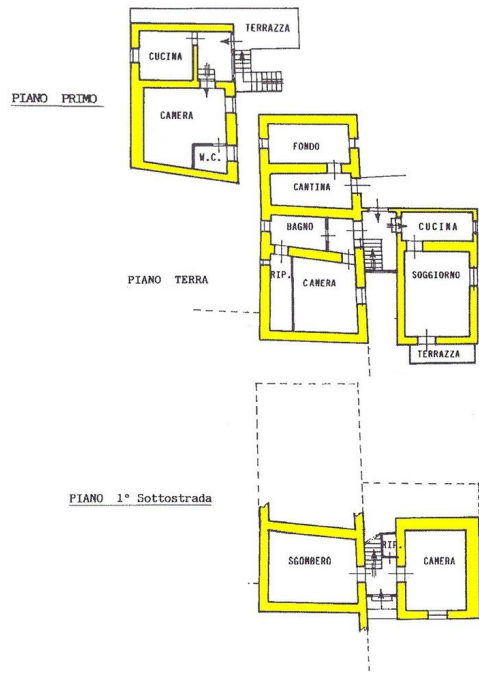

LUMENANA 2000
 10100000

