



LUNIGIANA 2000

real estate

Ref. 474A

Village house



BESCHREIBUNG

Village house on two levels with **terrace-solarium** and panoramic views set in a charming borgo, popular for the thermal spa and the tourist caves.

The property consists of:

- **Terrace**, dining room with open plan kitchen and stairwell on ground floor;
- Hallway, single bedroom, hall, two bedrooms and bathroom with shower on first floor.

Central heating (natural gas).

The property also includes a beautiful terrace-solarium with panoramic views.

TECHNISCHE DETAILS

Nutzfläche

65 m²

Außenfläche

95 m²

Lärmpegel

0 - zona molto silenziosa

Stockwerke

2

Zimmer

4

Schlafzimmer

3

Badezimmer

1

Innenhof

Ja

Terrasse

Ja

Vorbau

Ja

Höhe ü. d. M.

270

Energieklasse

281.36 Kw/h m²

Status

abitabile

Heizung

Autonomo a gas metano

Panoramablick

Ja

Möbliert

Ja

Kategorie

G

MESSAGES.PROPERTY_IMAGES



































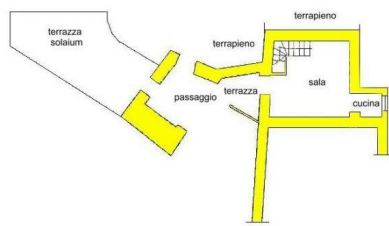

PIANO SEMINTERRATO S1



PIANO TERRA

LINGUANA 2000

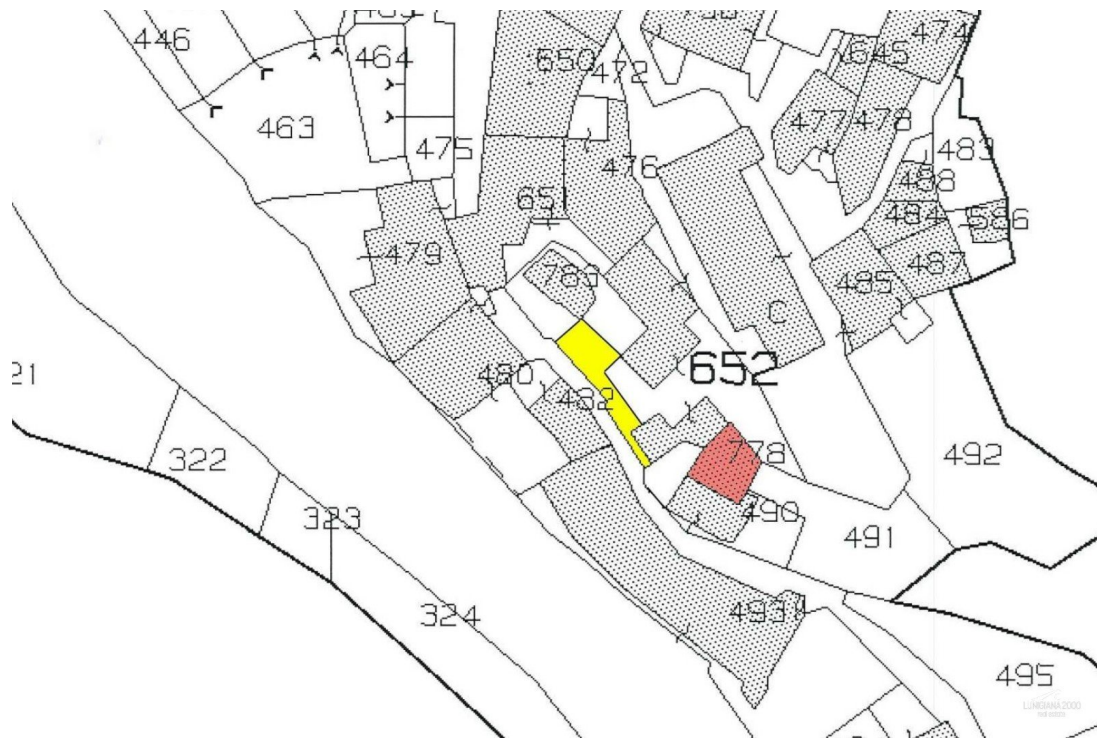

LINGUANA 2000