



# LUNIGIANA 2000

real estate

**Ref. 039L**

---

# Detached house



## BESCHREIBUNG

**Detached house** with **garden, garage and roof terrace** set in a village where there are amenities and the train station.

Its present accommodation offers:

- three cellars and garage on lower ground floor;
- dining room, kitchen, two bathrooms and two bedrooms on ground floor;
- terrace on first floor.

## Central heating (natural gas)

It is possible to park 3 cars at the house

## TECHNISCHE DETAILS

Nutzfläche  
160 m<sup>2</sup>  
Außenfläche  
200 m<sup>2</sup>  
Lärmpegel  
3 - zona di media rumorosità  
Stockwerke  
2  
Zimmer  
6  
Schlafzimmer  
3  
Badezimmer  
2  
Grundstück  
285 m<sup>2</sup>  
Innenhof  
285 m<sup>2</sup>  
Keller  
70 m<sup>2</sup>  
Garage  
Ja  
Terrasse  
20 m<sup>2</sup>  
Vorbau  
Ja  
Höhe ü. d. M.  
300  
Status  
abitabile  
Heizung  
Caldia a pellet

## **Kategorie**

G

MESSAGES.PROPERTY\_IMAGES









































LUMINARIA 2000  
red estate

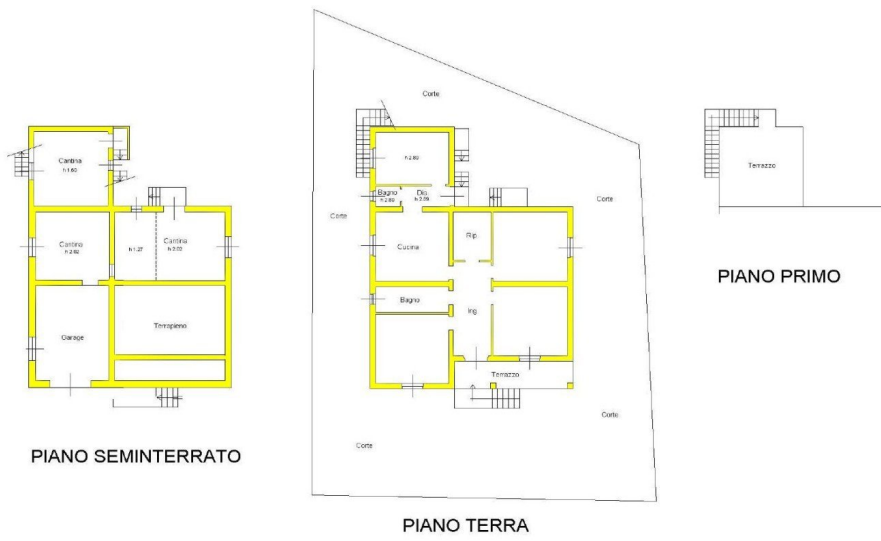

LUMINARIA 2000  
red estate