



# LUNIGIANA 2000

real estate

**Ref. 178A**

# Stone building



## BESCHREIBUNG

**Stone building** on two levels with **land** of approximately 1.000 sq m set at 635 meters above sea level in a sunny position with beautiful panoramic views.

The property, which **requires total restoration**, has an easy access through an asphalt road and comprises:

- storage room and **courtyard** on ground floor;
- storage room and **courtyard** on first floor.

In addition to making the change of use - from a barn into a house -, it is also possible to make a beautiful pool.

## TECHNISCHE DETAILS

Nutzfläche  
45 m<sup>2</sup>  
Außenfläche  
65 m<sup>2</sup>  
Lärmpegel  
0 - zona molto silenziosa  
Stockwerke  
2  
Zimmer  
2  
Schlafzimmer  
1  
Badezimmer  
1  
Grundstück  
1038 m<sup>2</sup>  
Innenhof  
25 m<sup>2</sup>  
Keller  
Ja  
Höhe ü. d. M.  
635  
Status  
da ristrutturare  
Heizung  
Inesistente

## **Kategorie**

G

MESSAGES.PROPERTY\_IMAGES

















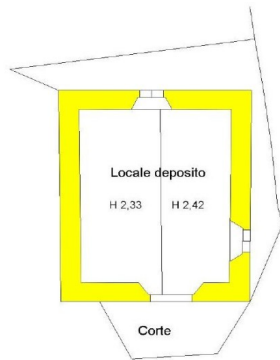

PIANO TERRA



PIANO PRIMO