



# LUNIGIANA 2000

real estate

**Ref. 1022**

---

# First-floor apartment



## BESCHREIBUNG

**First-floor apartment** (206 sq m) overlooking one of the most prestigious square of Pontremoli in a palazzo which has been recently restored.

The flat, which has vaulted ceilings with frescoes and original floors, comprises:

- entrance hall, kitchen, two bathrooms, large living room with fireplace, three bedrooms, passage room and room used as pantry-laundry room.

The apartment can be divided into two units because there is a double entry.

**No central heating.**

**To be restored.**

## **TECHNISCHE DETAILS**

Nutzfläche

175 m<sup>2</sup>

Außenfläche

206 m<sup>2</sup>

Lärmpegel

2 - zona abbastanza silenziosa

Zimmer

7

Schlafzimmer

4

Badezimmer

1

Höhe ü. d. M.

236

Status

da riordinare

Heizung

Inesistente

## **Kategorie**

G

MESSAGES.PROPERTY\_IMAGES

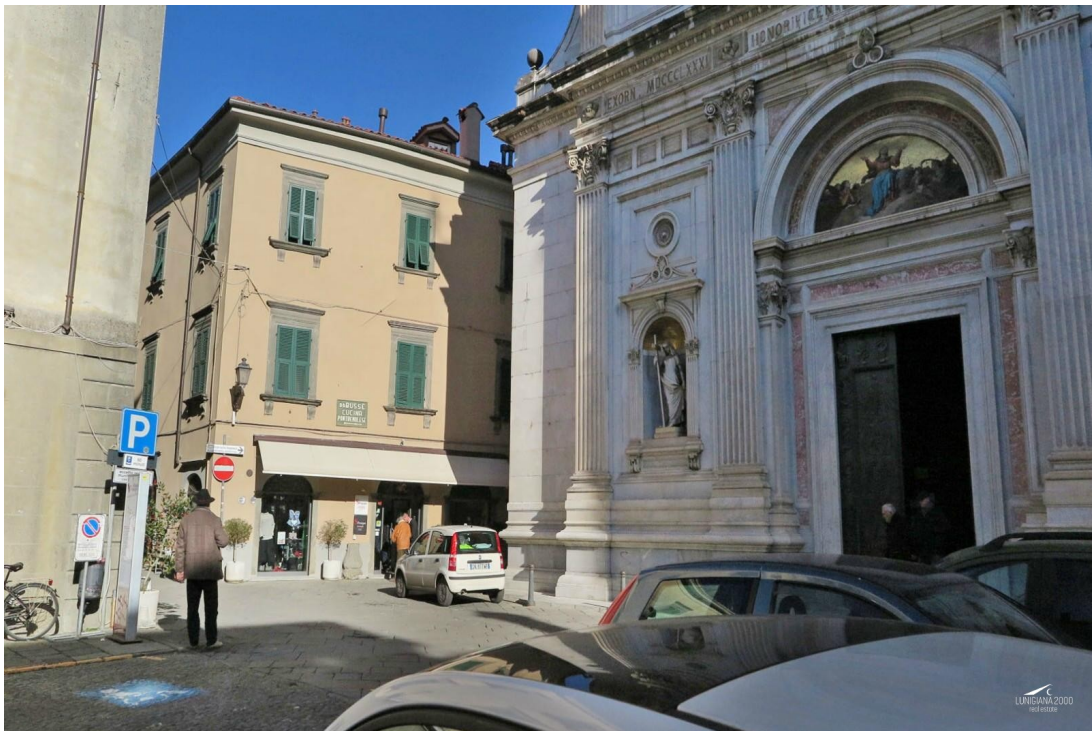



























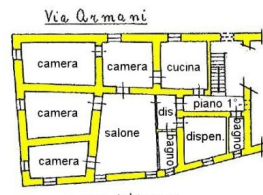

Piazza del Duomo  
-PIANTA PIANO PRIMO- h. s. c. o