



LUNIGIANA 2000

real estate

Réf. 012A

Detached house



DESCRIPTION

Detached house with **land** of 580 sq m and **outbuilding** requiring renovation set in an hillside position, just 10 minutes far from the beautiful medieval town of Pontremoli.

The property (165 sq m) comprises:

- Entrance hall, bedroom and vaulted cellar on ground floor;
- Landing, kitchen, living room, panoramic **terrace** with amazing views over the valley, hall, double bedroom, bathroom with bath and two vaulted cellars on first floor accessible through an internal staircase.

The outbuilding (55 sq m) to be renovated consists of:

- Veranda entrance hall, kitchen, bedroom and bathroom on second floor.

Central heating (natural gas).

DÉTAILS TECHNIQUES

Surface habitable

210 m²

Surface extérieure

250 m²

Niveau sonore

0 - zona molto silenziosa

Étages

2

Pièces

4

Chambres

3

Salles de bain

2

Jardin

580 m²

Terrain

580 m²

Cour

Oui

Cave

Oui

Terrasse

Oui

Altitude m s.n.m.

450

Classe énergétique

262.32 Kw/h m²

État

abitabile

Chauffage

Autonomo a gas metano

Vue panoramique

Oui

Meublé

Oui

Catégorie

G

MESSAGES.PROPERTY_IMAGES



































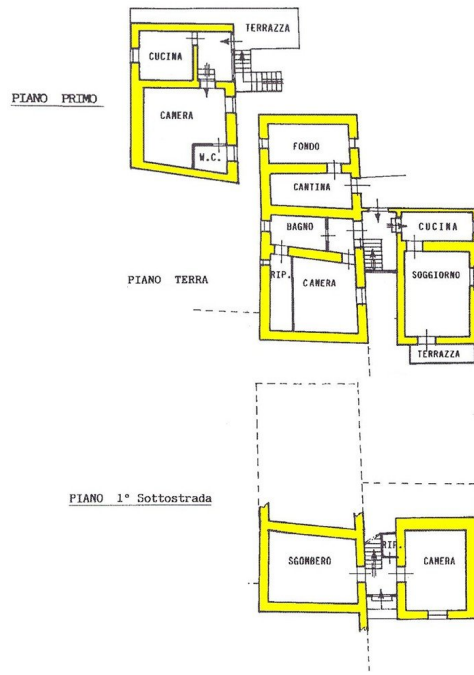

LUMENANA 2000
 10/000000

