



LUNIGIANA 2000

real estate

Réf. 474A

Village house



DESCRIPTION

Village house on two levels with **terrace-solarium** and panoramic views set in a charming borgo, popular for the thermal spa and the tourist caves.

The property consists of:

- **Terrace**, dining room with open plan kitchen and stairwell on ground floor;
- Hallway, single bedroom, hall, two bedrooms and bathroom with shower on first floor.

Central heating (natural gas).

The property also includes a beautiful terrace-solarium with panoramic views.

DÉTAILS TECHNIQUES

Surface habitable

65 m²
Surface extérieure
95 m²
Niveau sonore
0 - zona molto silenziosa
Étages
2
Pièces
4
Chambres
3
Salles de bain
1
Cour
Oui
Terrasse
Oui
Portique
Oui
Altitude m s.n.m.
270
Classe énergétique
281.36 Kw/h m²
État
abitable
Chauffage
Autonomo a gas metano
Vue panoramique
Oui
Meublé
Oui

Catégorie

G

MESSAGES.PROPERTY_IMAGES



































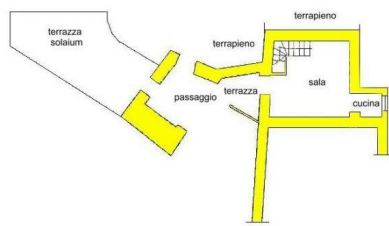

PIANO SEMINTERRATO S1



PIANO TERRA

LINGUANA 2000

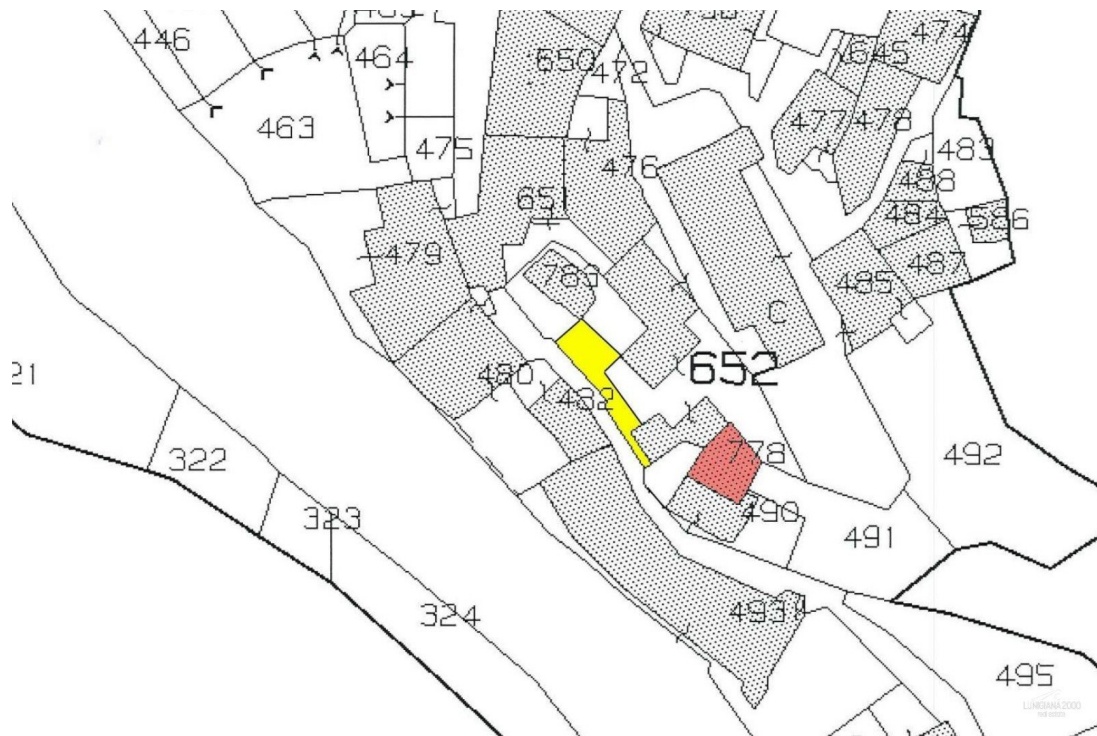

LINGUANA 2000