



# LUNIGIANA 2000

real estate

**Réf. 355**

---

# Stone village house



## DESCRIPTION

Typical **stone village house** with panoramic views over the valley set at 495 sq m above sea level and just 4 km far from the beautiful medieval town of Fivizzano.

Its present accommodation offers:

- exclusive **courtyard**, entrance hall, living room, kitchen, dining room and bathroom with shower on ground floor;
- hallway, four bedrooms, two of which have **terraces** and bathroom with bath on first floor.

**Central heating (natural gas).**

It is possible to park the car at approximately 10 meters far from the house.

## DÉTAILS TECHNIQUES

Surface habitable  
115 m<sup>2</sup>  
Surface extérieure  
170 m<sup>2</sup>  
Niveau sonore  
0 - zona molto silenziosa  
Étages  
2  
Pièces  
7  
Chambres  
4  
Salles de bain  
2  
Cour  
20 m<sup>2</sup>  
Cave  
Oui  
Terrasse  
4 m<sup>2</sup>  
Balcon  
4 m<sup>2</sup>  
Altitude m s.n.m.  
495  
État  
abitable  
Chauffage  
Autonome a gas metano  
Vue panoramique  
Oui  
Meublé  
Oui

## **Catégorie**

G

MESSAGES.PROPERTY\_IMAGES

































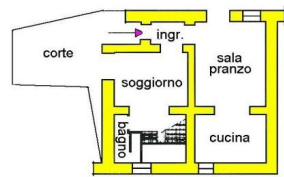

piano terra

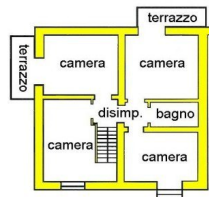

piano primo



PIANTA PIANO TERRA